

ACME Overland's
ADVENTURE READY

Albion



\$145,000*

**Financing available*



**SHOWN WITH OPTIONAL SPEC*

ADVENTURE VEHICLES FOR YOUR NEXT ESCAPE

Introducing ACME Overland's adventure van solution to get you on (and off!) the road - ASAP! Our 'Adventure Ready' Albion ALLRAD has been developed as a turn-key adventure vehicle solution. We feel it fits the needs of an adventurous young family without sacrificing the quality, finish, and technology ACME Overland has become known for.

INTERIOR Specifications



STANDARD FEATURES;

- Seats 4 sleeps 4
- Ford OEM swivel seats
- 2 person moveable/removeable bench seat
- Overhead lighting, bed lamps, & cabinet lights
- Red night light
- ACME Overland's operating system w/ app (IOS and android)
- Lightweight aluminum 3-panel bed (72"x 76")
- Double lower bunk, moveable/removeable bed (66"x30")
- All season insulation

Warranty - One year on ACME Overland's craftsmanship and components.

INTERIOR Floorplan

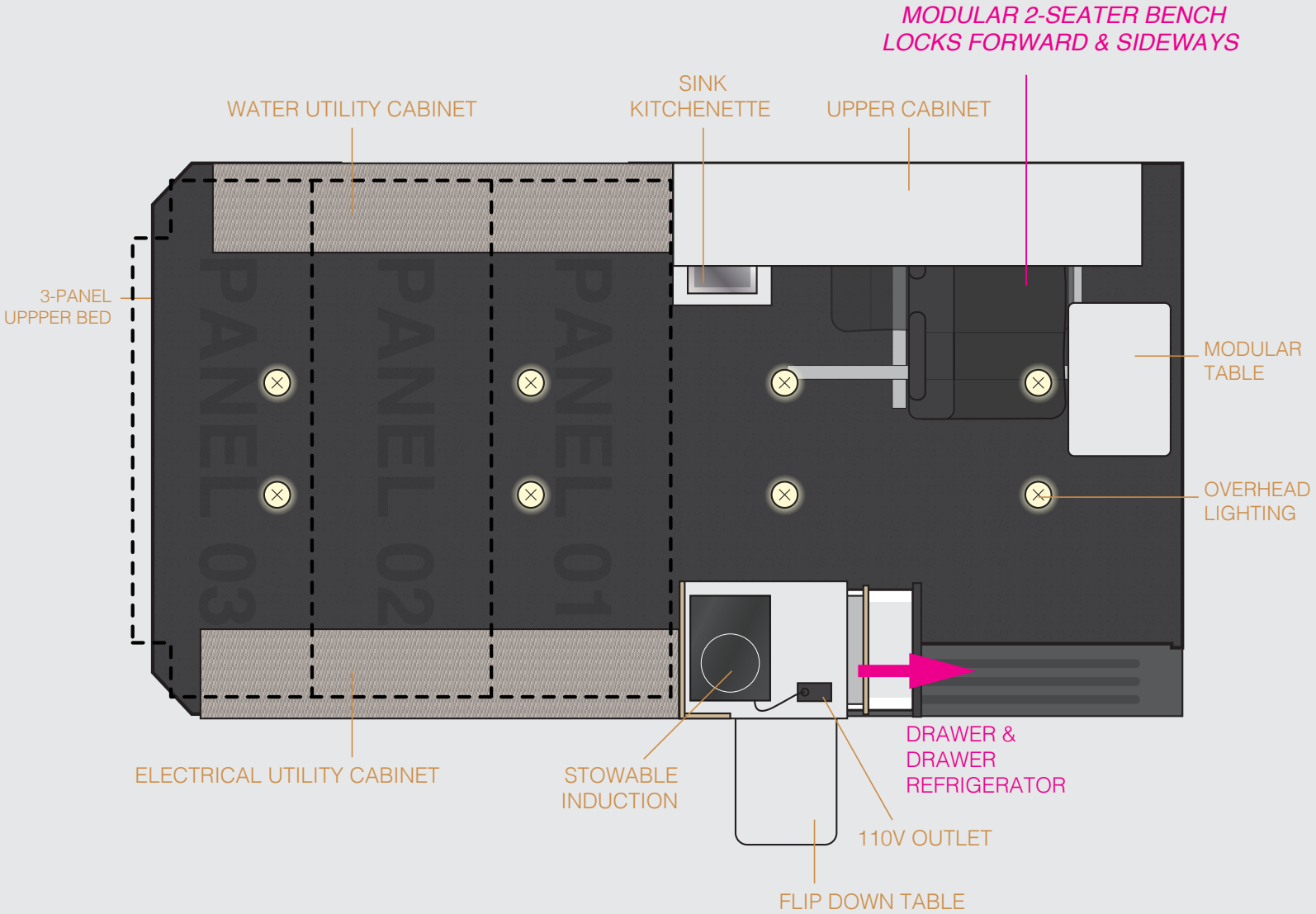

SURFACES:

FORWARD →





ACME Overland's 'Adventure Ready' Albion ALLRAD was developed for a plethora of activities in summer or winter. While materials and technology are advanced, we aim for simplicity allowing the user to only have to focus on their travels!

EXTERIOR Specifications



STANDARD FEATURES;

- ACME Overland's adaptable bold rack w/ aero flow faring
- Maxxair networked high flow fan
- Solar panel (100w)
- Forward facing light bar (50")
- Driver & passenger side, vented panoramic windows w/ screen
- Vented bed windows w/ screens (driver and passenger side, 10x33")
- Exterior flood light over passenger door
- ACME Overland's 'pattern 01' protective hood wrap

- Rear hitch w/ tow package
- Shore charge plug
- 180 degree backup camera
- Reverse flood lights (x2)
- Exterior Flip Down Table*

***Shown with optional 12v auxillary Dometic A/C

Warranty - One year on ACME Overland's craftsmanship and components.

UPGRADES

- Front Bumper*
- Rear Bumper*
- Brush Guard*
- Side Ladder*
- Rear Door Ladder*
- Expandable Solar (+~400w)*
- Audio*
- Alarm*
- Bike Mounts*
- Ski Mounts*
- Maxx Trax Recovery Treads*
- Rear Door Storage Boxes*
- Walkable Roof Platform*
- Internal 12v powered fans*
- Rhino Lining*
- Upgraded Suspension**
- 2" Van Compass Lift Kit**
- Additional Exterior Lighting*
- Wheels**
- Tires**
- Air Compressor*
- Vehicle Graphic Wrap*
- Additional Storage Hooks**
- Window Tint*
- Dometic awning*
- Not seeing what you need, let us know!*

**Van shown in photos with options spec*

CHASSIS Specifications

2021 FORD TRANSIT 350 AWD
11,200LBS GVWR

148" LONG HIGH ROOF

3.5L V6 ECOBOOST®

5,200LBS TOWING CAPACITY

31 GALLON EXTENDED FUEL TANK
GASOLINE, 14 CITY / 18 HWY MPG

*SHOWN WITH OPTIONAL SPEC

VEHICLE COLOR OPTIONS:

'CARBONIZED GRAY' SHOWN

'BLUE JEANS'

'AVALANCHE GRAY'

'ABYSS GRAY'

Window Sticker Details

- 2021 350 HR CARGO AWD
- 148" WHEELBASE
- 3.5L ECOBOOST V6 (GAS) INTERIOR
- 10-SPEED TRANSMISSION
- INTERIOR DARK PALAZZO GRAY CLOTH

EXTERIOR

- AUXILIARY FUEL PORT
- BUMPERS - CARBON BLACK
- DOOR - SINGLE SLIDING SIDE
- DOORS - CARGO REAR W/
- 180-DEGREE SWING-OUT
- FULL SIZE SPARE TIRE/WHEEL

INTERIOR

- AIR CONDITIONING
- ASSIST HANDLES - A-PILLAR
- CENTER CONSOLE W/STORAGE
- INTERIOR LIGHTING - LED
- LOCKING GLOVE BOX
- POWERPOINT - 12V (FRONT)
- STEERING - TILT/TELESCOPIC

FUNCTIONAL

- HEADLAMP COURTESY DELAY
- WIPERS - RAIN-SENSING FUNCTIONAL
- AUTO HIGH-BEAM HEADLAMPS
- ELECTRONIC PWR ASST STEER
- FORDPASS™ CONNECT 4GWI-FI HOTSPOT TELEMATICS MODEM
- FORWARD COLLISION WARNING
- HILL START ASSIST
- LANE-KEEPING SYSTEM
- POST-COLLISION BRAKING
- PRE-COLLISION ASSIST W/AEB
- REAR VIEW CAMERA
- W/ TRAILER HITCH ASSIST
- SELECTABLE DRIVE MODES
- SIDE-WIND STABILIZATION
- SUSPENSION - HEAVY DUTY FRONT AXLE

SAFETY/SECURITY

- 3 POINT SAFETY BELTS
- ADVANCETRAC® WITH RSC®
- AIRBAGS FRONT, SIDE & SAFETY CANOPY® SYSTEM
- BRAKES - 4WHEEL DISC W/ABS
- SECURILOCK® ANTI-THEFT SYS
- SOS POST-CRASH ALERT SYS™
- TIRE PRESSURE MONIT SYS

OPTIONAL EQUIPMENT ADDED

- 3.73 LIMITED SLIP AXLE
- WHEEL WELL LINERS
- FIXED REAR CARGO DOOR GLASS
- 253 DEGREE OPENING
- 9500# GVWR PACKAGE
- B-PILLAR ASSIST HANDLE
- REVERSE SENSING SYSTEM
- RV PREP PACKAGE
- CARPET FRONT FLOOR COVERING
- 4WAY D/P SWVL PALAZZO CLOTH
- HD TRAILER TOW PACKAGE
- BODY COLORED FRONT BUMPER
- FRONT FOG LAMPS
- ADAPTIVE CRUISE CONTROL
- ILLUMINATED SUN VISORS
- WIPER ACTIVATED HEADLAMPS
- SIDE SENSING SYSTEM
- KEYLESS ENTRY PAD
- RADIO - SYNC3, 8" SCN
- PERIMETER ANTI-THEFT ALARM
- VEHICLE MAINTENANCE MONITOR
- FRONT/REAR SPLITVIEW CAMERA
- BLIS W/ CROSS-TRAFFIC ALERT
- EXTENDED FUEL TANK (31 GAL)
- FRONT OVERHEAD SHELF
- UPFITTER PACKAGE
- MODIFIED VEHICLE WIRING SYS
- DUAL BATTERIES (70 AMP-HR)
- LARGE CENTER CONSOLE
- AUXILIARY FUSE PANEL
- SCUFF PLATE KIT
- 2 ADDITIONAL KEYS
- POWERPOINT (12V)
- PRIVACY GLASS

WARRANTY

- 3YR/36,000 BUMPER / BUMPER
- 5YR/60,000 POWERTRAIN
- 5YR/60,000 ROADSIDE ASSIST

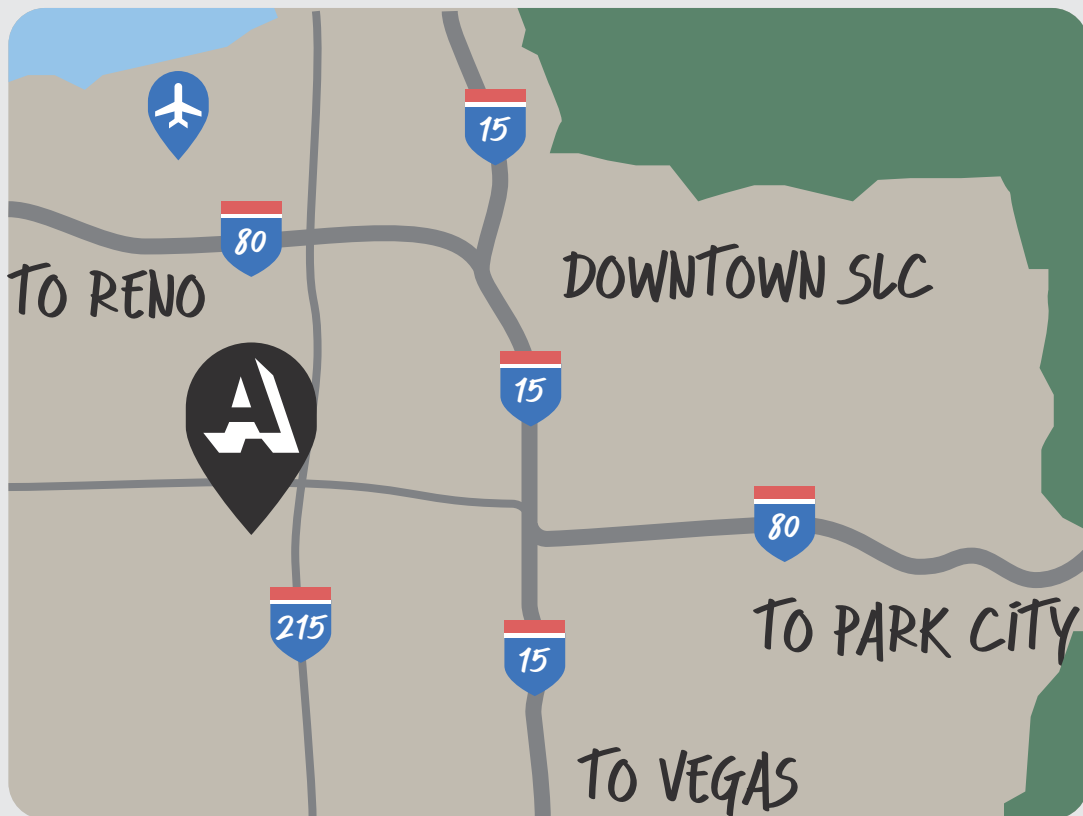

USE YOUR PHONE'S
CAMERA ON THE
QR CODE!

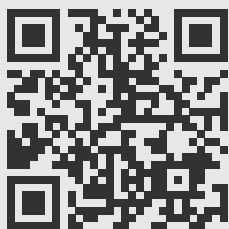

web: acmeoverland.com

e: hello@acmeoverland.com